

Vol. 4

No. 2

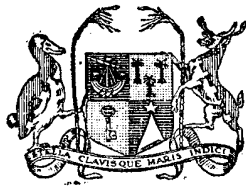

COLONY OF MAURITIUS

CENTRAL STATISTICAL OFFICE

**QUARTERLY
DIGEST OF STATISTICS**

June 1964

[Price : Rs 2.50]

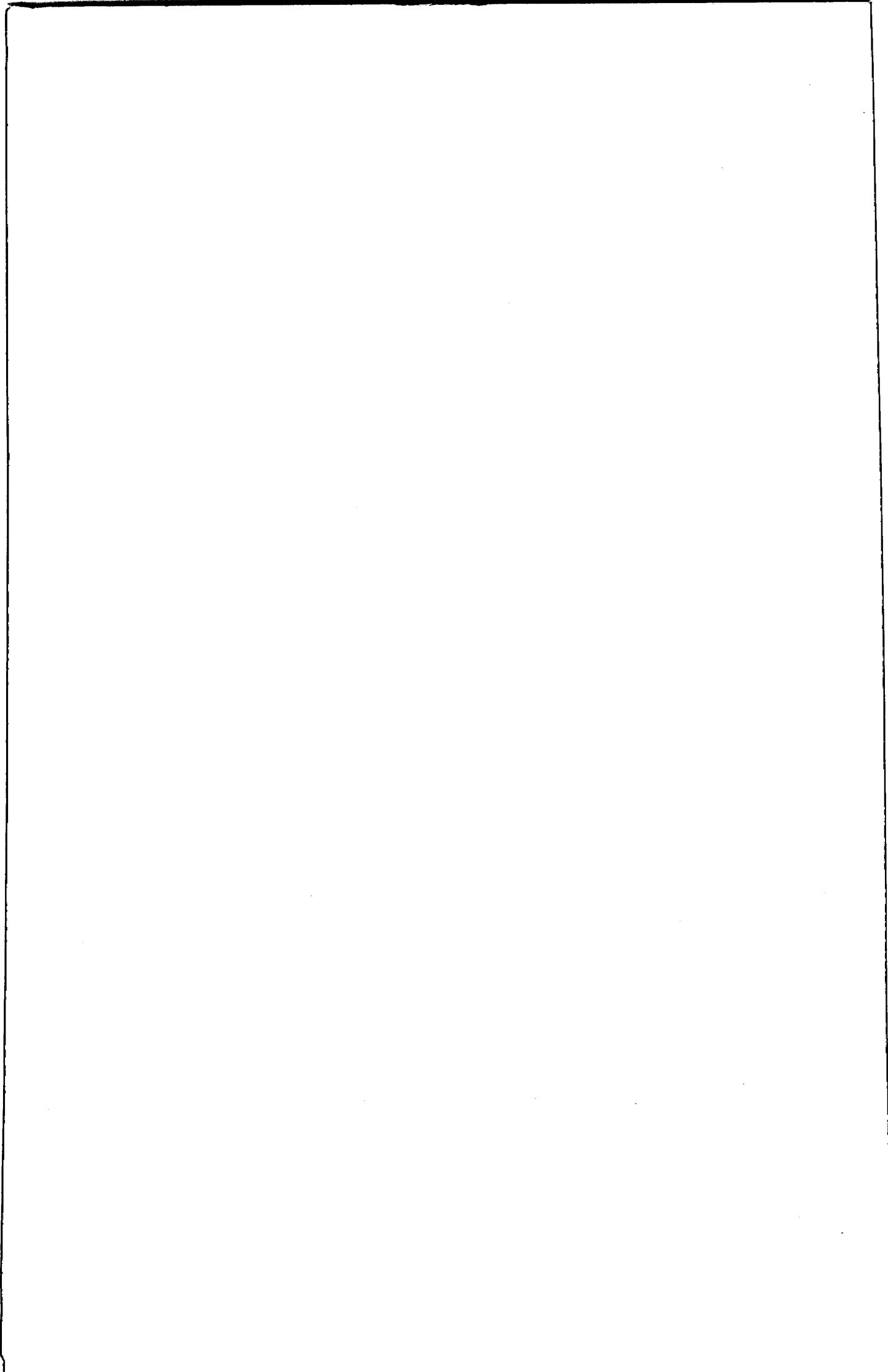

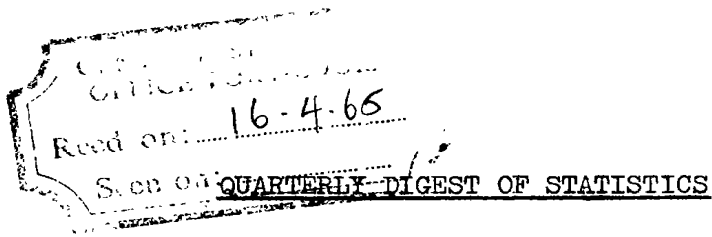

NOTES

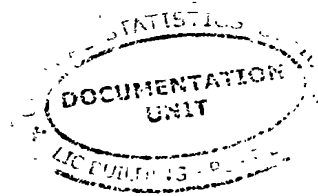

The following symbols are used throughout: -

- Nil or negligible

... Not available

2. Some of the figures in this Digest are liable to revision in later issues.

3. Where necessary figures have been rounded off to the nearest final digit, and in some tables there may be discrepancies between the sum of the constituent items and the total as shown.

Central Statistical Office,
Mauritius.

CONTENTS

Page

I. POPULATION AND VITAL STATISTICS

Table 1 - Population and Vital Statistics	1
2 - Live-births and still-births	1
3 - Total deaths and infant deaths	2
4 - External migration	2

II. PUBLIC HEALTH

Table 5 - Statistics of Hospitals	3
6 - Notifiable, Contagious or Communicable diseases	4

III. PUBLIC FINANCE

Table 7 - Central Government Revenue & Expenditure: Recurrent	5
8 - Central Government Revenue & Expenditure: Capital	5
9 - Government Borrowing	5
10 - Sterling Assets	6
11 - Banking Statistics: Assets of Commercial Banks	7
12 - " " : Liabilities of Commercial Banks	8
13 - " " : Assets of the Development Bank of Mauritius & The Mauritius Housing Corporation	9
14 - " " : Liabilities of the Development Bank of Mauritius & The Mauritius Housing Corporation	10
15 - Post Office Savings Bank	11
16 - Currency in Circulation	11
17 - Gross National Product	12
18 - Gross Fixed Domestic Capital Formation	13
19 - Balance of Payments	14

IV. CONSUMER PRICE INDICES

Table 20 - Consumer Price Indices	15
-----------------------------------	----

V. EXTERNAL TRADE

Table 21 - Balance of Visible trade	16
22 - Quantum and price indices of exports and imports and the terms of trade	16
23 - Quantum and price indices of imports by section	17
24 - Exports - Quantities and values	18
25 - Exports: Principal countries of destination - values	19
26 - Imports - Values	20
27 - " : Selected commodities - values	21
28 - " : " " - quantities	22
29 - " : Main sources of supply - values	23

CONTENTS (Cont'd)

	Page
VI. <u>TRANSPORT AND COMMUNICATION</u>	
Table 30 - Road Transport	24
31 - Sea borne shipping	25
32 - Civil Aviation	25
VII. <u>LAND UTILISATION</u>	
Table 33 - Total area classified by utilisation	26
VIII. <u>LOCAL PRODUCTION</u>	
Table 34 - Production of specific commodities	27
IX. <u>EDUCATION</u>	
Table 35 - Roll of pupils and students in schools and colleges	28

I. POPULATION AND VITAL STATISTICS

Table 1 - Population and Vital Statistics

Period	Marriages	Births	Deaths	Natural Increase	Net		Estimated Population at the end of the period
					Overseas Migration	Total Increase	
1959	3,297	23,923	6,753	17,170	+ 93	17,263	637,203
1960	3,113	25,307	7,248	18,059	- 372	17,687	654,890
1961	3,484	26,092	6,505	19,587	- 1,179	18,408	673,298
1962	3,893	26,267	6,325	19,942	- 887	19,055	692,353
1963	3,472	27,978	6,709	21,269	- 241	21,028	713,381
1963 : 1st Qr.	720	6,412	1,561	4,851	- 495	4,356	696,709
2nd Qr.	929	6,858	1,772	5,086	- 363	4,723	701,432
3rd Qr.	894	7,520	1,877	5,643	- 118	5,525	706,957
4th Qr.	929	7,188	1,499	5,689	+ 735	6,424	713,381
1964 : 1st Qr.	809	6,206	1,627	4,579	- 839	3,740	717,121
2nd Qr.	1,015	6,834	1,482	5,352	- 384	4,968	722,089

Revision of population estimates prior to 1962 based on data obtained from the 1962 Population Census.

Table 2 - Live Births and Still Births

Period	LIVE BIRTHS			Still Births
	Total	Males	Females	
1959	23,923	12,107	11,816	1,759
1960	25,307	12,973	12,334	1,783
1961	26,092	13,244	12,848	1,963
1962	26,267	13,395	12,872	1,841
1963	27,978	14,263	13,715	1,519
1963 : 1st Qr.	6,412	3,295	3,117	335
2nd Qr.	6,858	3,475	3,383	372
3rd Qr.	7,520	3,850	3,670	430
4th Qr.	7,188	3,643	3,545	382
1964 : 1st Qr.	6,206	3,077	3,129	306
2nd Qr.	6,834	3,489	3,345	395

Table 3 - Total Deaths and Infant Deaths

	Total Deaths			Infant Deaths		
	Total	Males	Females	Total	Males	Females
1959	6,753	3,499	3,254	1,495	821	674
1960	7,248	3,706	3,542	1,760	980	780
1961	6,505	3,359	3,146	1,618	915	703
1962	6,325	3,255	3,070	1,579	896	683
1963	6,709	3,457	3,252	1,660	929	731
1963 : 1st Qr.	1,561	784	777	432	236	196
2nd Qr.	1,772	907	865	369	197	172
3rd Qr.	1,877	1,017	860	534	314	220
4th Qr.	1,499	749	750	325	182	143
1964 : 1st Qr.	1,627	831	796	484	301	183
2nd Qr.	1,482	750	732	375	209	166

Table 4 - External Migration⁺

Period	Arrivals			Departures			Net migration
	Total	By sea	By Air	Total	By Sea	By Air	
1959	9,637	4,231	5,406	9,544	4,222	5,325	+ 93
1960	10,412	4,063	6,349	10,784	4,464	6,320	- 372
1961	11,854	4,402	7,452	13,033	5,442	7,591	- 1,179
1962	15,188	4,258	10,930	16,075	4,374	11,701	- 887
1963	17,974	4,660	13,314	18,215	4,432	13,783	- 241
1963 : 1st Qr.	3,760	1,028	2,732	4,255	1,215	3,040	- 495
2nd Qr.	3,727	879	2,848	4,090	949	3,141	- 363
3rd Qr.	5,776	1,255	4,521	5,894	1,302	4,592	- 118
4th Qr.	4,711	1,498	3,213	3,976	966	3,010	+ 735
1964 : 1st Qr.	4,456	1,157	3,299	5,295	1,444	3,851	- 839
2nd Qr.	4,603	949	3,654	4,987	1,195	3,792	- 384

⁺Includes: - (a) The very small figure of engaged or discharged seamen;
 (b) Emigrants and immigrants to and from the dependencies; and
 (c) Movement of military personnel as from 1962 Population Census.

II. PUBLIC HEALTH

Table 5 - Statistics of Hospitals

Period	No. of beds	Patients in hospital on 1st day of period	Total Admissions	Deaths	Discharges	Patients remaining on last day of period
1959	2,270	1,580	34,846	1,344	33,455	1,627
1960	2,357	1,627	34,355	1,560	32,766	1,656
1961	2,448	1,656	36,892	1,601	35,196	1,751
1962	2,453	1,751	38,130	1,628	36,480	1,773
1963	2,453	1,773	45,717	1,959	43,686	1,845
1963 : 1st Qr.	2,453	1,773	10,570	520	9,661	2,162
2nd Qr.	2,453	2,162	10,858	443	10,438	2,139
3rd Qr.	2,453	2,139	12,400	550	11,862	2,127
4th Qr.	2,453	2,127	11,889	446	11,725	1,845
1964 : 1st Qr.	2,481	1,845	12,085	494	11,288	2,148
2nd Qr.	2,481	2,148	12,688	467	12,149	2,220

Table 6 - Notifiable, Contagious or Communicable Diseases

Disease Period	Typhoid	Diphtheria	Acute poliomyelitis	Puerperal fever	Erysipelas	Cerebro- spinal meningitis	Tuberculosis	Leprosy	Murine typhus
1959	45	140	99	5	2	-	300	-	-
1960	114	164	1	3	2	1	313	2	-
1961	71	215	-	1	-	-	353	1	-
1962	81	151	1	-	-	-	300	-	3
1963	89	145	3	2	2	-	429	4	3
1963 : 1st Qr.	19	65	1	-	-	-	71	4	-
2nd Qr.	24	42	1	-	2	-	106	-	1
3rd Qr.	26	28	1	-	-	-	114	-	-
4th Qr.	20	10	-	2	-	-	138	-	2
1964 : 1st Qr.	12	27	-	1	-	-	94	-	1
2nd Qr.	19	113	-	-	-	-	145	-	-

III. PUBLIC FINANCE

Table 7 - Central Government Revenue and Expenditure: Recurrent

Period	Revenue				Expenditure	
	Total	Direct Taxes	Indirect Taxes	Other	Total including Debt Charges	Debt Charges
1959	129.8	47.1	66.0	16.7	129.5	6.6
1960	141.0	43.2	79.6	18.2	145.9	7.9
1961	144.9	40.3	82.8	21.8	150.1	8.9
1962	154.8	38.3	97.2	19.3	164.9	9.3
1963	168.8	41.0	102.9	24.9	164.6	10.6
1963 : 1st Qr.	44.8	8.9	30.7	5.2	37.9	3.0
2nd Qr.	44.1	11.3	22.9	9.9	44.5	1.6
3rd Qr.	33.8	6.3	22.9	4.6	36.5	3.6
4th Qr.	46.1	14.5	26.4	5.2	45.7	2.4
1964 : 1st Qr.	51.9	6.6	41.0	4.3	47.0	3.2
2nd Qr.	52.7	13.9	27.7	11.1	51.1	2.7

Table 8 - Central Government Revenue and Expenditure: Capital

Period	Revenue					Total Expenditure
	Total	Contributory	Grants	Loans	Other	
1959	20.3	1.8	0.9	15.9	1.7	29.8
1960	32.6	14.0	2.0	15.4	1.2	45.8
1961	43.1	12.0	18.3	12.0	0.8	47.4
1962	43.8	12.0	13.3	18.3	0.2	62.9
1963	72.3	6.0	9.1	56.4	0.8	53.2
1963 : 1st Qr.	13.4	-	5.3	8.1	-	13.5
2nd Qr.	27.4	-	2.7	24.1	0.6	17.5
3rd Qr.	4.2	-	-	4.1	0.1	9.8
4th Qr.	27.3	6.0	1.1	20.1	0.1	12.4
1964 : 1st Qr.	20.9	6.0	3.2	10.9	0.8	11.5
2nd Qr.	20.1	-	1.8	18.1	0.2	20.0

Table 9 - Central Government Indebtedness

Period	Amount outstanding at beginning of period	Borrowing			Repayments
		Total	Internal	External	
1959-60	98.0	29.8	29.8	-	0.5
1960-61	127.3	16.9	9.3	7.6	0.5
1961-62	143.7	13.5	8.0	5.5	0.5
1962-63	156.7	39.2	24.6	14.6	7.5
1963 : Jan.-March	157.1	7.6	2.1	5.5	0.4
April-June	164.3	24.2	15.5	8.7	0.1
July-Sept.	188.4	4.4	2.1	2.3	0.5
Oct.-Dec.	192.3	20.1	0.5	19.6	0.1
1964 : Jan.-March	212.3	11.3	2.8	8.5	0.2
April-June	223.4	18.3	2.2	16.1	0.3

Table 10 - Sterling Assets
(end of period)

Rs Million

Period	INVESTMENTS (Nominal Value)				LIQUID ASSETS (Cash and money at call)					Net Balances of banks due from banks abroad	
	Government	Semi-Governmental Institutions	Currency Backing	Post Office Savings Bank	Total	Government	Semi-Governmental Institutions	Currency Backing	Post Office Savings Bank		Total Government & semi-governmental Institutions
1959	52.0	64.7	60.1	26.3	203.1	20.4	49.9	28.8	4.1	103.2	52.4
1960	42.9	79.4	66.0	26.3	214.6	18.3	2.3	15.5	4.1	35.6	16.2
1961	26.4	64.8	60.5	25.8	177.5	24.1	42.8	26.8	2.2	10.3	35.1
1962	29.4	20.5	59.6	23.3	132.8	3.0	6.5	28.7	2.1	27.3	21.0
1963	32.6	8.8	45.7	23.1	110.2	3.0	1.2	46.5	4.3	52.6	108.0
1963 : 1st Qr.	30.3	20.5	53.3	23.2	127.3	6.3	8.3	31.5	2.7	32.2	4.3
2nd Qr.	31.4	20.5	46.7	23.2	121.8	18.5	8.4	21.0	2.7	33.8	82.3
3rd Qr.	32.0	9.6	46.4	23.2	111.2	5.9	0.4	31.9	2.1	40.3	11.8
4th Qr.	32.6	8.8	45.7	23.1	110.2	12.0	1.2	46.5	4.3	61.6	108.0
1964 : 1st Qr.	32.8	8.8	45.7	23.0	110.3	11.0	1.1	41.1	5.4	58.6	129.4
2nd Qr.	34.8	8.8	45.6	22.7	111.9	22.2	8.7	36.8	5.0	72.7	40.3

Table 11 - Banking Statistics - Assets of Commercial banks

Period	Total	Cash	Balances due by		Loans and Advances			Investments		Other Assets	
			Other Banks in the colony	Banks abroad	Primary products	Other industries	Other advances	Local	Abroad	Bills discounted and bills receivable	Other
1959: 31st Dec.	186.3	7.2	7.1	54.4	25.9	31.0	9.7	5.5	2.0	7.2	36.3
1960: "	194.2	7.5	2.3	26.4	45.0	45.0	13.6	5.5	2.0	13.8	33.1
1961: "	241.2	6.0	3.0	57.1	53.3	45.7	21.8	5.0	2.0	11.8	35.5
1962: "	229.2	6.4	0.9	46.4	57.4	44.0	20.9	5.0	2.0	10.7	35.5
1963: "	281.9	8.9	3.3	113.2	28.5	41.8	19.9	6.4	2.0	10.5	47.4
1963: 31st March	230.8	6.9	2.0	31.0	69.8	50.4	16.5	5.0	2.0	10.7	36.5
30th June	256.5	6.8	1.2	6.2	106.2	49.2	24.3	5.4	2.0	15.0	40.2
30th Sept.	228.8	6.5	1.8	20.8	68.1	51.0	15.6	5.4	2.0	12.7	44.9
31st Dec.	281.9	8.9	3.3	113.2	28.5	41.8	19.9	6.4	2.0	10.5	47.4
1964: 31st March	313.3	10.2	1.5	130.1	32.8	50.7	19.6	6.5	2.0	11.3	48.6
30th June	271.8	8.6	1.7	50.7	52.0	49.1	30.4	6.5	5.0	14.5	53.3

Rs Million

Table 12 - Banking Statistics - Liabilities of Commercial banks

Rs Million

Period	Total	Notes in circulation	Deposits			Balances due to		Other Liabilities
			Demand	Time	Savings	Other banks in the colony	Banks abroad	
1959 : 31st Dec.	186.3	-	115.0	5.1	10.5	2.6	2.0	51.1
1960 : "	194.2	-	113.3	3.0	11.6	2.7	10.2	53.4
1961 : "	241.2	-	143.5	3.6	12.5	3.7	22.0	55.9
1962 : "	229.2	-	124.5	7.3	15.2	1.3	25.5	55.4
1963 : "	281.9	-	174.7	10.7	20.7	4.3	5.2	66.3
1963 : 31st March	230.8	-	106.3	15.0	16.3	2.5	35.3	55.4
: 30th June	256.5	-	81.8	8.2	17.1	1.8	88.5	59.1
: 30th Sept.	228.8	-	103.4	8.7	18.3	2.3	32.7	63.4
: 31st Dec.	281.9	-	174.7	10.7	20.7	4.3	5.2	66.3
1964 : 31st March	313.3	-	206.1	14.4	24.0	1.9	0.7	66.2
: 30th June	271.8	-	134.7	27.7	24.6	2.3	10.4	72.1

Table 13 - Banking Statistics - Assets of the Development Bank of Mauritius and the Mauritius Housing Corporation

Period	Total	Cash	Balances due by			Loans and Advances			Investments			Other Assets
			Other banks in the colony	Banks abroad	Primary products	Other industries	Other Advances	Local	Abroad	Other		
											Other banks in the colony	
1959 : 31st Dec.	42.6	0.1	0.6	-	26.0	0.8	10.0	0.8	0.6	3.7		
1960 : "	40.0	0.1	0.9	-	25.5	0.8	9.7	0.8	0.7	1.5		
1961 : "	42.4	-	0.9	-	25.2	0.8	11.8	0.9	0.7	2.1		
1962 : "	46.3	-	1.6	-	24.4	0.8	14.0	1.0	0.9	3.6		
1963 : "	45.8	-	1.3	-	23.4	1.0	14.7	1.1	0.9	3.4		
1963 : 31st March	45.0	-	1.5	-	24.2	0.8	14.1	1.0	0.9	2.5		
: 30th June	45.7	0.1	1.9	-	24.0	0.9	14.2	1.1	0.9	2.6		
: 30th Sept.	46.1	-	1.5	-	23.7	0.9	14.7	1.1	0.9	3.3		
: 31st Dec.	45.8	-	1.3	-	23.4	1.0	14.7	1.1	0.9	3.4		
1964 : 31st March	46.5	-	1.4	-	23.2	1.0	14.9	1.1	0.9	4.0		
: 30th June	45.8	-	1.1	-	22.7	1.0	15.1	1.1	0.9	3.9		

Rs Million

Table 14 - Banking Statistics - Liabilities of the Development Bank of Mauritius and the the Mauritius Housing Corporation

Rs Million

Period	Total	Notes in circulation	Deposits			Balances due to		Other Liabilities
			Demand	Time	Savings	Other banks in the colony	Banks abroad	
1959 : 31st Dec.	42.6	-	-	5.1	2.1	-	-	35.4
1960 : "	40.0	-	-	4.9	2.1	-	-	33.0
1961 : "	42.4	-	0.7	7.0	2.1	-	-	32.6
1962 : "	46.3	-	0.7	9.6	2.0	-	-	34.0
1963 : "	45.8	-	0.5	9.0	2.2	-	-	34.1
1963 : 31st March	45.0	-	0.6	9.4	2.0	-	-	33.0
: 30th June	45.7	-	0.5	9.4	2.0	-	-	33.8
: 30th Sept.	46.1	-	0.5	9.4	2.1	-	-	34.1
: 31st Dec.	45.8	-	0.5	9.0	2.2	-	-	34.1
1964 : 31st March	46.5	-	0.4	8.8	2.2	-	-	35.1
: 30th June	45.8	-	0.4	8.8	2.2	-	-	34.4

Table 15 - Post Office Savings Bank

Period	Deposits	Withdrawals	Accumulated Balance	Number of Accounts
	during period		at the end of period	
	Rs Mn	Rs Mn	Rs Mn	
1959	17.2	14.9	32.1	...
1960	15.3	16.9	31.3	...
1961	11.9	13.4	30.4	...
1962	13.9	15.3	29.8	...
1963	15.4	13.4	32.6	...
1963 : 1st Qr.	3.5	3.4	29.9	...
2nd Qr.	2.6	3.1	30.2	86,052
3rd Qr.	4.3	3.5	31.0	...
4th Qr.	5.0	3.4	32.6	...
1964 : 1st Qr.	4.7	3.4	33.9	...
2nd Qr.	3.3	3.6	34.4	84,642

Table 16 - Currency in circulation
(end of period)

Rs Million

Period	Notes	Coins	Total	Cash held by banks	Net circulation
1959	73.2	4.6	77.8	7.2	70.6
1960	73.1	4.5	77.6	7.5	70.1
1961	77.7	4.5	82.2	6.0	76.2
1962	77.3	4.9	82.2	6.4	75.8
1963	95.8	5.3	101.1	8.9	92.2
1963 : 1st Qr.	73.2	4.6	77.8	6.9	70.9
2nd Qr.	71.9	4.6	76.5	6.8	69.7
3rd Qr.	80.0	5.1	85.1	6.5	78.6
4th Qr.	95.8	5.3	101.1	8.9	92.2
1964 : 1st Qr.	88.6	5.1	93.7	10.2	83.5
2nd Qr.	84.2	5.0	89.2	8.6	80.6

Table 17 - Industrial Origin of Gross National Product
(At current factor cost)

	Rs Million			
	1959	1960	1961	1962 ⁺
1. Agriculture, forestry, hunting and fishing	205	112	194	192
2. Mining and quarrying	1	1	1	1
3. Manufacturing	117	70	121	122
4. Construction	34	35	50	51
5. Electricity, gas, water and sanitary services	12	12	14	17
6. Transportation, storage and communication	90	84	94	97
7. Wholesale and retail trade	65	67	74	75
8. Banking, insurance and real estate	12	13	13	14
9. Ownership of dwellings	47	42	50	53
10. Public Administration and defence	27	27	29	30
11. Services	64	69	72	77
GROSS DOMESTIC PRODUCT AT FACTOR COST	674	532	712	729
Net factor income from abroad	7	10	- 5	- 5
GROSS NATIONAL PRODUCT AT FACTOR COST	681	542	707	724

⁺provisional.

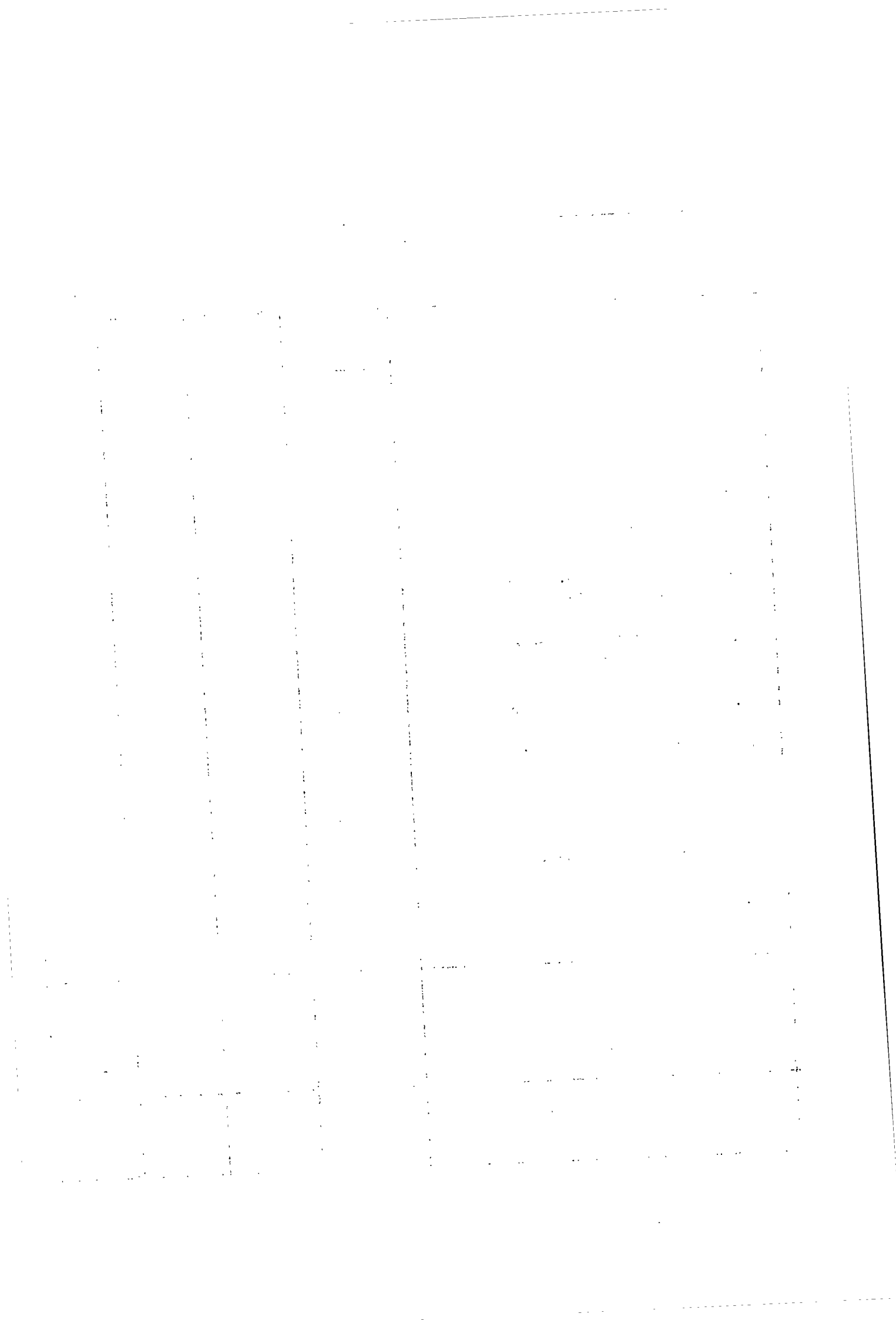

Table 18 - Composition of Gross Fixed Domestic Capital Formation
(at current prices)

Rs Million

	1959	1960	1961	1962	1963 [@]
A. By type of capital good					
a. Land ^x	2	3	3	2	2
b. Dwellings	25	30	42	42	45
c. Non-residential buildings	13	13	18	14	13
d. Other construction and works	24	23	29	37	38
e. Transport equipment	15	19	18	16	16
(i) Passenger cars	4	6	5	5	5
(ii) Other equipment	11	13	13	11	11
f. Machinery and other equipment	44	46	39	30	43
GROSS FIXED DOMESTIC CAPITAL FORMATION⁺	123	134	149	141	157
B. By industrial use					
a. Agriculture, forestry, and fishing	21	17	13	15	9
b. Mining and quarrying	-	-	-	-	-
c. Manufacture	28	28	24	20	21
d. Construction	2	3	2	2	3
e. Electricity, gas and water	13	13	13	12	30
f. Transportation, storage and communication	17	25	28	23	20
g. Wholesale and retail trade	3	4	5	3	3
h. Banking, insurance and real estate	-	-	-	1	1
i. Ownership of dwellings	25	30	43	44	49
j. Public Administration	9	8	13	14	14
k. Service industries	3	3	5	5	5
l. Legal fees, stamp duties, etc	2	3	3	2	2
GROSS FIXED DOMESTIC CAPITAL FORMATION⁺	123	134	149	141	157

⁺Excluding the expenditure incurred on reconstruction of and abnormal repairs to buildings damaged by cyclones and valued as follows: -

1960 : Rs 60 M
1961 : Rs 6 M
1962 : Rs 5 M
1963 : Rs 2 M

^xIncluding legal fees, stamp duties, agents' commissions etc., connected with the transfer of ownership of land and buildings.

[@]Provisional.

Table 19 - Balance of Payments

	Rs Million									
	1959		1960		1961		1962		1963 ⁺	
	Receipts	Payments	Receipts	Payments	Receipts	Payments	Receipts	Payments	Receipts	Payments
Goods and services	325.8	324.9	248.5	368.5	343.0	378.2	339.3	377.0	463.4	388.5
Donations	2.6	6.2	5.8	5.7	21.2	8.8	16.7	9.8	11.7	8.5
Capital Transactions	47.7	39.8	105.8	21.4	97.8	55.5	90.4	51.5	62.7	141.5
Net Credit or Debit Balance	-	5.2	35.5	-	-	19.6	-	8.1	0.7	-
TOTAL	376.1	376.1	395.6	395.6	462.1	462.1	446.4	446.4	538.5	538.5

⁺ provisional.

IV. CONSUMER PRICE INDICES

Table 20 - Consumer Price Indices

(Base :January-June 1962 = 100)

The table below gives for the period April, 1962 to June, 1964, three consumer price indices, viz: -

- (a) an index for households in urban areas;
- (b) an index for households in rural areas;
- (c) a total index for Mauritius as a whole.

Period	Urban	Rural	Total
<u>1962</u>			
April	101.2	101.6	101.4
May	100.5	100.5	100.5
June	98.5	98.4	98.4
July	98.5	98.6	98.5
August	99.0	99.2	99.1
September	99.5	99.3	99.4
October	99.1	99.2	99.1
November	98.1	98.2	98.1
December	96.8	97.0	96.9
<u>1963</u>			
January	98.6	99.0	98.8
February	99.3	99.6	99.4
March	98.0	98.2	98.1
April	97.3	97.4	97.4
May	97.5	97.5	97.5
June	97.4	97.4	97.4
July	98.1	98.1	98.1
August	98.3	98.2	98.2
September	98.9	98.8	98.8
October	100.2	100.2	100.2
November	99.3	99.2	99.2
December	98.6	98.6	98.6
<u>1964</u>			
January	100.2	100.2	100.2
February	104.3	104.2	104.3
March	102.9	102.9	102.9
April	101.7	101.8	101.7
May	99.5	99.0	99.2
June	98.4	97.9	98.1

V. EXTERNAL TRADE

Table 21 - Balance of Visible Trade

Rs Million

Period	Imports (C.I.F. Value)	Exports ⁺ (F.O.B. Value)	Balance of visible trade	
			Surplus	Deficit
1959	286.9	289.6	2.7	-
1960	331.9	185.0	-	146.9
1961	324.0	294.2	-	29.8
1962	322.7	305.9	-	16.8
1963	333.1	427.8	94.7	-
1963 :1st Qr.	76.7	20.2	-	56.5
2nd Qr.	85.7	7.9	-	77.8
3rd Qr.	82.8	212.3	129.5	-
4th Qr.	88.0	187.5	99.5	-
1964 :1st Qr.	76.4	76.4	-	-
2nd Qr. ^x	96.9	17.6	-	79.3

Table 22 - Quantum and price indices of exports and imports and terms of trade
(1956 = 100)

Period	Quantum Indices		Price Indices		Terms of trade
	Export	Import	Export	Import	
1959	96	132	101	97	104
1960	57	154	109	96	114
1961	98	150	101	96	105
1962	100	152	102	95	107
1963	111	153	130	97	134

⁺Including value of sugar quota certificates, but excluding sales value of bunker fuel and ships' stores.

For the year 1963 the value of sugar quota certificates has been included in the 4th quarter.

^xprovisional.

^zRatio of export price index to import price index.

A rise in the index indicates that the terms of trade have moved in favour of Mauritius.

Table 23 - Quantum and Prices of Imports by sections
(1956 = 100)

Period	All Sections	Food	Beverages and Tobacco	Crude materials inedible, except fuels	Mineral fuels, lubricants etc.	Animal and vegetable oils and fats	Chemicals	Manufactured goods classified chiefly by material	Machinery and transport equipment	Miscellaneous manufactured articles
<u>Quantum Indices</u>										
1959	132	127	122	86	107	98	132	121	182	172
1960	154	143	142	90	104	133	145	158	198	235
1961	150	151	148	102	99	127	149	141	179	197
1962	152	157	143	78	127	135	156	138	148	218
1963	153	161	136	66	114	167	166	139	174	179
<u>Price Indices</u>										
1959	97	99	105	102	89	86	91	92	111	89
1960	96	98	105	104	90	86	87	98	106	78
1961	96	97	105	102	83	90	88	96	108	102
1962	95	97	105	103	86	88	87	91	110	108
1963	97	96	107	107	88	81	88	90	115	119

Table 24 - Exports: Quantities and values

Quantity: Thousand Metric Tons
Value : Rs Million F.O.B.

Period	DOMESTIC EXPORTS											
	Total Value [‡]	Re-exports Value	Total		Sugar		Molasses		Tea		Other	
			Quantity	Value	Quantity	Value	Quantity	Value	Quantity	Value	Quantity	Value
1959	289.6	4.0	...	285.6	512.0	276.9	60.0	4.8	0.5	2.7	...	1.2
1960	185.0	5.5	...	179.5	299.4	174.0	45.2	3.4	0.2	1.3	...	0.8
1961	294.2	10.5	...	283.7	505.7	272.2	64.6	5.0	0.8	4.9	...	1.6
1962	305.9	8.8	...	297.1	515.1	282.0	110.3	9.1	0.7	3.9	...	2.1
1963	427.8	6.8	...	420.9	574.3	400.2	109.8	13.5	1.0	5.5	...	1.8
1963 : 1st Qr.	20.2	1.8	...	18.4	22.6	13.4	19.3	1.6	0.4	2.7	...	0.7
2nd Qr.	7.9	1.8	...	6.1	4.6	2.8	13.6	1.4	0.3	1.6	...	0.3
3rd Qr.	212.3	1.8	...	210.5	279.6	204.8	37.2	5.2	-	0.2	...	0.3
4th Qr. ^x	187.5	1.5	...	186.0	267.5	179.2	39.7	5.3	0.2	1.0	...	0.5
1964 : 1st Qr.	76.4	1.6	...	74.8	91.2	69.5	28.6	3.5	0.2	1.4	...	0.4
2nd Qr. ⁺	17.6	1.4	...	16.2	17.1	12.7	12.3	1.5	0.3	1.4	...	0.6

[‡]Including value of sugar quota certificates, but excluding sales value of bunker fuel and ships' stores.

⁺provisional.

^xThe value of sugar quota certificates has been included in the 4th quarter of 1963.

Table 25 - Total Exports[‡] : Principal Countries of destination - values

Period	Rs Million F.O.B.									
	United Kingdom	Canada	Hong-Kong	Federation of Malaysia	Nyasaland	Holland	Italy	Japan	Lebanon	United States of America
1959	229.6	37.5	3.0	1.4	2.2	1.6	-	0.8	2.9	0.1
1960	159.5	10.0	-	0.7	0.9	1.0	-	1.5	-	-
1961	235.9	36.4	0.1	-	-	0.1	-	2.3	-	3.5
1962	251.0	22.3	0.3	0.1	-	2.0	0.5	3.0	-	9.2
1963	290.7	66.7	0.1	0.1	0.2	0.1	8.4	0.6	-	47.8
1963 : 1st Qr.	16.3	-	-	0.1	-	-	0.1	0.1	-	1.5
2nd Qr.	4.4	-	-	-	0.2	-	-	0.4	-	1.2
3rd Qr.	124.8	51.8	-	-	-	-	-	-	-	33.8
4th Qr.	145.1	14.9	-	-	-	-	8.3	0.1	-	11.3
1964 : 1st Qr.	62.2	-	-	-	-	-	11.0	0.1	-	1.5
2nd Qr. ⁺	14.3	-	-	-	-	1.5	0.4	0.1	-	-

[‡]excluding value of sugar quota certificates.

⁺provisional.

Table 26 - Imports - Values

Period	Rs Million c.i.f.										
	Total	Food	Beverages and Tobacco	Crude materials, inedible, except fuels	Mineral fuels, lubricants, etc.	Animal and vegetable oils and fats	Chemicals	Manufactured goods classified chiefly by material	Machinery and transport equipment	Miscellaneous manufactured articles	Miscellaneous transactions n.e.s.
1959	286.9	76.8	7.0	7.0	13.5	7.6	32.8	62.8	56.1	22.8	0.5
1960	331.9	85.2	8.1	7.4	13.2	10.3	34.4	86.9	58.5	27.3	0.6
1961	324.0	88.9	8.4	8.2	11.7	10.3	36.0	76.0	53.7	29.9	0.9
1962	322.7	93.0	8.1	6.3	15.5	10.7	37.2	70.9	45.4	34.9	0.7
1963	333.1	94.7	7.9	5.6	14.2	12.1	39.7	70.8	55.7	31.7	0.8
1963 : 1st Qr.	76.7	23.4	1.9	1.7	4.1	3.5	7.6	17.6	9.7	6.9	0.2
2nd Qr.	85.7	23.2	1.7	1.5	3.7	3.6	8.5	18.3	17.4	7.7	0.1
3rd Qr.	82.8	21.7	1.7	1.1	3.1	3.0	12.8	17.5	14.9	6.9	0.2
4th Qr.	88.0	26.4	2.7	1.4	3.2	2.0	10.8	17.3	13.7	10.2	0.2
1964 : 1st Qr.	76.4	19.6	1.3	1.1	3.9	2.7	8.4	18.8	13.7	6.8	0.1
2nd Qr.†	96.9	27.2	1.6	1.7	4.5	2.8	9.3	22.5	18.6	8.7	-

† provisional.

Table 27 - Imports of Merchandise: selected commodities - values

Period	Rs Million c.i.f.													
	Rice	Wheat flour	Alcoholic beverages	Petroleum products	Vegetable edible oils	Fertilizers, manufactured	Cotton fabrics	Other textile fabrics	Cement	Iron and steel goods	Manufactures of metals n.e.s.	Machinery, other than electric	Electric machinery, apparatus and appliances	Road motor vehicle and parts
1959	32.4	7.4	4.7	12.5	7.1	14.3	11.0	6.2	7.1	10.5	7.1	21.1	20.2	13.0
1960	33.0	10.0	6.0	12.9	9.7	13.2	12.1	5.9	9.9	23.0	12.8	21.6	19.6	15.5
1961	36.8	9.4	6.8	10.9	9.8	12.9	12.2	6.5	9.1	13.8	11.8	20.2	17.5	13.8
1962	37.3	11.6	6.4	15.0	10.0	14.9	12.7	5.6	8.8	11.1	9.6	18.2	12.0	13.8
1963	38.3	12.1	5.9	13.8	11.5	16.4	12.1	6.5	7.4	9.0	12.0	17.8	22.0	13.8
1963 : 1st Qr.	6.9	5.1	1.4	4.0	3.3	1.5	2.8	1.4	1.8	2.2	3.5	2.5	4.0	2.7
2nd Qr.	11.7	1.9	1.1	3.7	3.4	2.8	2.9	1.4	2.3	2.0	3.1	6.4	6.6	3.5
3rd Qr.	9.9	1.4	1.3	3.0	2.8	6.4	3.4	1.9	1.8	2.4	2.9	4.3	7.0	3.3
4th Qr.	9.7	3.6	2.1	3.1	2.0	5.8	3.0	1.8	1.5	2.5	2.6	4.6	4.3	4.4
1964 : 1st Qr.	5.2	2.8	0.9	3.9	2.6	2.3	2.9	1.9	2.2	3.2	2.7	4.9	3.2	4.9
2nd Qr. [†]	10.1	2.3	1.2	4.3	2.6	3.0	3.7	2.1	2.5	3.6	3.5	7.6	4.5	5.6

[†]provisional.

Table 28 - Imports of merchandise: selected commodities - quantities

Period	Rice	Wheat flour	Vegetable edible oils	Fertilizers manufactured	Cotton fabrics	Other textile fabrics	Cement	Iron and steel goods
	Thousand M/Tons	Thousand M/Tons	Thousand M/Tons	Thousand M/Tons	Million Sq. metres	Million Sq. metres	Thousand M/Tons	Thousand M/Tons
1959	57.1	17.7	5.0	50.1	9.6	3.6	62.1	12.9
1960	60.6	23.9	7.1	51.3	9.1	2.4	94.6	26.7
1961	67.2	22.7	6.5	50.3	9.0	2.8	91.8	16.8
1962	68.2	26.6	6.8	62.7	10.0	2.5	95.2	14.2
1963	69.7	28.2	8.2	66.7	9.6	2.0	80.4	12.9
1963 : 1st Qr.	12.4	12.0	2.5	6.6	2.5	0.5	19.6	3.4
2nd Qr.	21.1	4.4	2.4	11.5	2.2	0.5	25.1	2.7
3rd Qr.	18.3	3.3	1.9	24.6	2.6	0.5	18.7	3.4
4th Qr.	17.8	8.4	1.4	24.0	2.3	0.5	17.1	3.4
1964 : 1st Qr.	8.9	6.1	1.8	9.5	2.2	0.7	25.4	4.7
2nd Qr.+	18.4	5.0	1.8	10.7	2.9	0.7	27.7	5.0

+provisional.

Table 29 - Imports: Main sources of supply - values

Period	Rs Million c.i.f.											
	United Kingdom	Australia	Burma	Hong-Kong	India	Republic of South Africa	Western Germany	Iran	Japan	Siam	France	United States of America
1959	105.9	19.5	28.6	7.1	12.7	20.0	11.9	10.6	9.2	6.2	9.4	8.5
1960	115.9	23.0	26.8	9.4	13.5	21.7	13.0	9.7	13.4	8.8	13.0	9.5
1961	104.8	22.4	28.9	9.7	13.8	27.1	15.0	8.2	9.7	10.0	12.9	7.6
1962	90.2	22.1	34.5	11.7	14.0	34.7	13.1	12.4	10.1	4.7	15.4	7.8
1963	94.2	19.3	34.7	11.7	13.0	30.8	13.0	10.3	9.7	4.3	17.2	9.0
1963 : 1st Qr.	21.3	4.7	5.8	2.2	4.0	9.2	2.5	2.5	2.3	1.4	5.6	1.4
2nd Qr.	24.1	3.3	10.1	2.9	2.7	8.4	3.2	2.8	1.9	1.7	4.2	3.4
3rd Qr.	24.5	3.8	9.6	2.6	3.7	6.7	3.5	2.5	2.0	0.4	3.5	1.8
4th Qr.	24.3	7.5	9.1	4.0	2.6	6.4	3.7	2.5	3.5	0.7	3.9	2.4
1964 : 1st Qr.	24.6	5.8	3.1	2.4	3.7	7.5	2.8	3.0	2.6	2.3	3.4	2.6
2nd Qr. ⁺	26.1	6.5	9.0	3.9	4.7	9.3	3.2	3.3	3.3	1.5	3.4	2.5

⁺ provisional.

VI. TRANSPORT AND COMMUNICATION

Table 30 - Road Transport

End of period	Grand Total	Private Vehicles				Commercial Vehicles					Government owned vehicles
		Total	Cars	Motor cycles	Other	Total	Taxi-cars	Buses ⁺	Lorries	Other	
1959	13,291	7,877	6,549	969	359	4,961	1,689	488	2,140	644	453
1960	14,083	9,181	7,649	1,092	440	4,401	1,274	447	1,901	779	501
1961	15,669	10,026	8,273	1,236	517	5,079	1,270	466	2,390	953	564
1962	16,673	10,847	8,860	1,400	587	5,224	1,194	498	2,470	1,062	602
1963	18,092	12,020	9,640	1,621	759	5,446	1,284	519	2,561	1,082	626
1963 : 1st Qr.	16,918	10,999	8,906	1,455	638	5,297	1,285	505	2,470	1,037	622
2nd Qr.	17,236	11,208	9,068	1,511	629	5,415	1,296	506	2,519	1,094	613
3rd Qr.	17,668	11,613	9,320	1,570	723	5,431	1,292	509	2,558	1,072	624
4th Qr.	18,092	12,020	9,640	1,621	759	5,446	1,284	519	2,561	1,082	626
1964:: 1st Qr.	18,577	12,213	9,934	1,706	573	5,734	1,297	518	2,590	1,329	630
2nd Qr.	19,158	13,037	10,208	1,762	1,067	5,482	1,338	564	2,645	935	639

⁺Figures for 1959 include private buses. Since 1960 these are grouped with "Other private vehicles".

Table 31 - Sea Borne Shipping

Period	Vessels Entering		Vessels Leaving		Goods	
	Number	Net registered tonnage	Number	Net registered tonnage	Unloaded	Loaded ⁺
		Thousand M/Tons		Thousand M/Tons	Thousand M/Tons	Thousand M/Tons
1959	365	1,363	367	1,352	425	589
1960	371	1,251	369	1,253	479	366
1961	418	1,510	419	1,508	478	604
1962	467	1,494	464	1,489	517	647
1963	493	1,593	487	1,601	466	701
1963 : 1st Qr.	98	340	101	347	110	46
2nd Qr.	99	319	98	316	124	20
3rd Qr.	146	454	140	455	120	325
4th Qr.	150	480	148	483	112	310
1964 : 1st Qr.	147	493	153	532	119	127
2nd Qr.	149	395	148	386	140	39

⁺including bunkers

Table 32 - Civil Aviation

Period	Number of movements		Passengers		Freight	
	Landings	Take offs	Set down	Picked up	Unloaded M/Tons	Loaded M/Tons
1959	255	256	5,371	5,325	51.4	39.7
1960	251	250	6,312	6,311	89.5	21.1
1961	287	288	7,645	7,775	201.6	70.8
1962	377	376	10,351	11,179	130.9	43.4
1963	390	390	12,912	13,405	120.4	51.5
1963 : 1st Qr.	92	91	2,701	3,007	20.4	7.1
2nd Qr.	95	96	2,798	3,019	33.8	14.3
3rd Qr.	106	105	4,268	4,449	26.5	14.1
4th Qr.	97	98	3,145	2,930	39.7	16.0
1964 : 1st Qr.	92	92	3,276	3,794	32.8	9.2
2nd Qr.	108	108	3,492	3,581	48.0	16.2

- Notes: In this table: (1) are included only movements of commercial aircraft;
(2) each touch down and take off is counted as a separate movement;
(3) passengers in transit are excluded;
(4) freight carried by planes other than commercial are included.

VII. LAND UTILISATION

Table 33 - Total area classified by utilisation

	<u>Acres</u>				
	1959	1960	1961	1962	1963
<u>Agriculture:</u>	221,100	225,200	226,300	229,400	228,700
Sugar	203,700	208,100	209,800	213,800	213,000
Aloe fibre (effective area)	2,400	2,000	2,200	1,100	1,000
Tea	4,000	4,400	4,400	4,900	5,300
Tobacco	1,100	1,000	900	700	800
Foodcrops	2,800	2,400	2,000	2,100	2,100
Vegetables	7,100	7,300	7,000	6,800	6,500
<u>Arable land potentially productive</u>	1,000	-	-	-	-
<u>Forests, scrub areas, grasslands and grazing grounds</u>	186,500	183,400	182,300	179,200	179,900
Private forestlands	15,000	15,000	15,000	15,000	15,000
Crown Forests	67,700	67,700	67,700	67,240	67,000
Pas Geometriques ^x	5,290	5,290	5,290	5,290	5,290
Natural reserves ⁺	15,500	15,500	15,500	15,500	15,500
Meadows, grass lands, scrubs forests and grazing grounds	83,010	79,910	78,810	76,170	77,110
<u>Built on areas</u>	14,200	14,200	14,200	14,200	14,200
<u>Inland water bodies</u>	23,000	23,000	23,000	23,000	23,000
Reservoirs, crater, lakes, ponds	3,000	3,000	3,000	3,000	3,000
Natural water courses	20,000	20,000	20,000	20,000	20,000
<u>Roads - tracks[@]</u>	10,000	10,000	10,000	10,000	10,000
<u>Permanent waste lands</u>	5,000	5,000	5,000	5,000	5,000
TOTAL ISLAND AREA	460,800	460,800	460,800	460,800	460,800

^x Leased crown lands in the coastal belt.

⁺ Privately owned mountain and river reserves protected by law.

[@] Estimated - including roads in agricultural lands.

VIII - LOCAL PRODUCTION

Table 34 - Production of Specific Commodities

Period	Sugar cane Thousand M/Tons	Sugar Thousand M/Tons	Molasses Thousand M/Tons	Alcohol (Total) @ 100° GL HL	Tea M/Tons	Tobacco leaf M/Tons	Cigarettes M/Tons	Rum ^x HL	Country liquor HL	Beer HL	Sacks Thousand units	Electricity generated Mn Kwh
1959	4,743.3	580.4	118.1	17,730	905.9	462.9	585.4	18,753	50,293	-	1,200.7	55.8
1960	2,393.5	235.8	73.0	19,536	786.0	459.8	618.3	16,096	49,517	-	1,270.0	54.6
1961	4,943.0	553.3	139.2	14,148	1,274.2	447.9	584.4	14,159	55,644	-	1,422.7	63.2
1962	4,624.5	532.8	125.6	15,460	1,269.8	424.4	576.7	14,440	57,812	-	1,500.2	77.2
1963	5,746.7	685.6	150.1	19,766	1,477.2	457.7	576.8	15,386	50,246	19,518	1,534.5	87.4
1963 : 1st Qr.	-	-	-	...	622.7	105.8	131.6	2,899	10,534	-	300.0	20.8
2nd Qr.	-	-	-	...	275.3	108.7	134.8	3,502	12,531	-	395.3	21.7
3rd Qr.	71.0	128.1	158.5	4,225	14,236	5,237	433.3	21.8
4th Qr.	508.2	115.1	151.9	4,760	12,945	14,281	405.9	23.1
1964 : 1st Qr.	-	-	-	...	524.8	101.5	131.0	3,157	9,363	10,087	244.3	21.6
2nd Qr.	-	-	-	...	260.2	115.1	147.5	3,738	12,361	7,048	401.1	23.3

^x issued for local consumption at 40°-50° GL.

IX - EDUCATION

Table 35 - Roll of pupils and students in schools and colleges

Period	PRIMARY SCHOOLS			SECONDARY SCHOOLS			
	Total	Government	Aided	Total	Government	Aided	Private
October 1959	105,223	59,876	45,347	18,489	1,360	2,435	14,694
" 1960	104,713	60,938	43,775	22,840	1,456	2,557	18,827
" 1961	113,604	66,497	47,107	24,851	1,629	2,602	20,620
" 1962	119,630	72,241	47,389	26,861	1,750	4,688	20,423
" 1963	124,049	75,672	48,377	28,134	1,945	4,900	21,289